

SPHERO

INTELLIGENCE BUILT IN



Ideal Standard

PART OF THE IDEAL STANDARD GROUP

SPHERO

INTELLIGENCE BUILT IN

04	Washroom Architecture
06	Intelligence built in
08	Developing a washroom revolution
10	Crafted from experience
12	Engineered for efficiency
14	Shaped to stand out
16	Key features
18	Enhancing every environment
26	Sculpted for superior hygiene
28	Designed to think ahead
30	Built with the future in mind
34	Engineered for easier maintenance
36	Product portfolio
39	Traditional flush
40	Waterless
41	Smart Hybrid flush
46	Accessories



WASHROOM ARCHITECTURE

Every element considered

Our washroom products are designed with architects in mind.

Together, we share an obsessive attention to detail – considering every part of every project, interrogating every element and fixating on every function so we can harmonise all aspects beneath one larger vision.

Our solutions are a response to the lifestyle needs of today and tomorrow, providing our partners with richer opportunities to meet project needs, beautifully.



INTELLIGENCE BUILT IN

THE STORY OF SPHERO



DEVELOPING A WASHROOM REVOLUTION

Redefining the urinal, revolutionising the washroom

There has been a renewed focus on the urinal in recent years. Increased concerns about the environment have put sustainability and water consumption in the spotlight, whilst advances in technology have led to functional progress.

Designed in partnership with the award-winning Studio Levien, Sphero combines the latest water-saving innovations with timeless aesthetics. It delivers a smarter urinal range that's fit for the modern world.

"We have taken an item that has historically been primarily about functionality and through a combination of high aesthetic design and great engineering completely reinvented it."

Robin Levien,
Designer

CRAFTED FROM EXPERIENCE

A heritage steeped in innovation

In collaboration with world-leading universities, architects and construction firms, we are working together to shape the future of modern living.

From our roots pioneering products like the ceramic disc cartridge, to delivering solutions for pressing global challenges, our mission has always been to make life better for our customers.

1902

One-piece Bathtub

1965

Skid-resistant Bathtub

1969

Ceramic Disc Cartridge

1979

The Rimless Toilet

1990

Top Fix

2000

Click Technology

2007

Markwik

2011

IdealBlue

2015

AquaBlade

2016

FirmaFlow

2017

Ipalyss

2019

Ceramic Disc 50th Anniversary

2020

Sphero Urinals



2015
AquaBlade



2019
Ceramic Disc 50th Anniversary



2020
Sphero Urinals

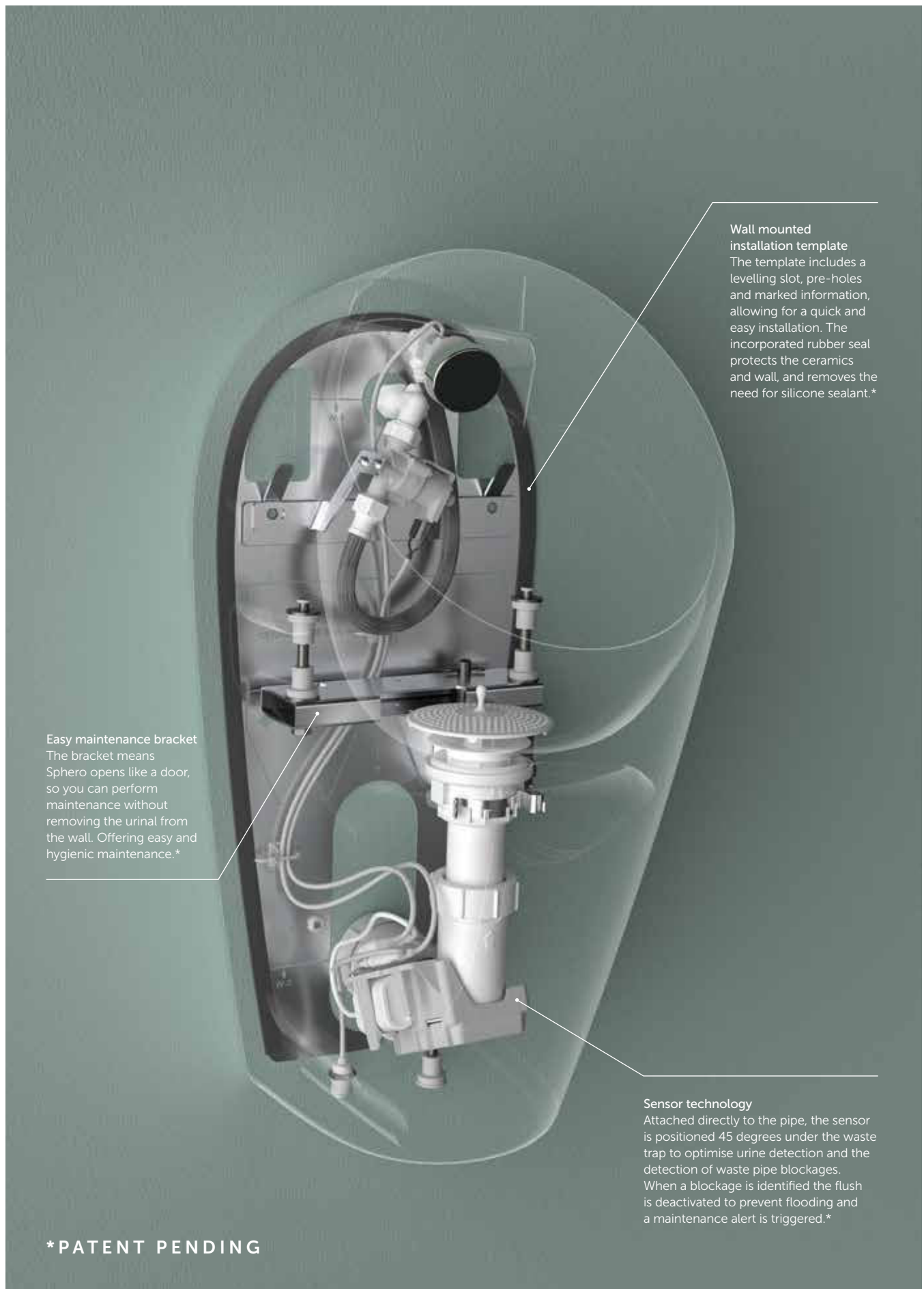

ENGINEERED FOR EFFICIENCY

Efficient at every level

Sphero has been developed with the future in mind. Our unique technology delivers water-saving benefits and outstanding hygiene, whilst providing ease of installation and maintenance.

The easy fix hanger and installation template make fitting smooth and efficient. A choice of back or top inlet models allow concealed or exposed installation, and the top fixed waste and patented easy maintenance bracket enable quick and easy access for on-wall maintenance.

The Smart Hybrid

Our Smart Hybrid flush system takes efficiency to new heights. Crafted for economy, it offers the benefits of a waterless unit with added hygiene.

Available in Midi or Maxi models, the smart sensor technology detects salinity and urinal use, activating flushes and using water only when needed. In high-traffic environments, this Hybrid revolution uses around 10 times less water than conventional urinals or infrared solutions that flush after every use.

Bluetooth provides the communication to our SPHERO app or through a gateway to the cloud. This access permits full usage and diagnostic information and allows complete control of the urinal mode settings (Hybrid, Waterless, Standard).

SHAPED TO STAND OUT

A statement in any washroom

Our partnership with Studio Levien has resulted in a product that is smart in every sense of the word.

Sphero's strikingly simple form belies the intelligence within its design. The fine edges not only achieve a modern aesthetic but are highly practical, helping to contain liquids in the bowl. The deep concave bowl has been designed to offer anti-splash geometry and optimum user privacy.

Each model uses the same rounded shape. It's instantly recognisable and a statement in any washroom.

"Together we set about harnessing the latest technologies to deliver easy cleaning, water saving, anti-splash and ease of installation."

Robin Levien,
Designer



Robin Levien, Designer

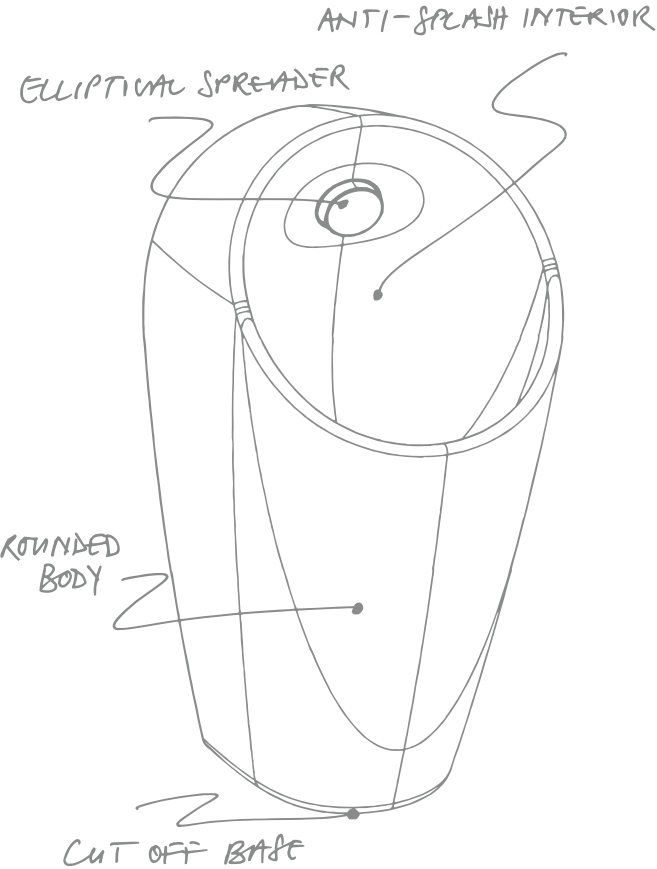

**KEY
FEATURES**

ENHANCING EVERY ENVIRONMENT

Shaped to suit all spaces

Sphero's considered, sophisticated design elevates and compliments contemporary washrooms.

Available in three sizes, each with multiple models, Sphero delivers an extensive range of simple solutions.



MINI



MIDI



MAXI



"We wanted all models to have the same distinctive form. It's a strong coordinated design but allows for size variations and adapts to every type of installation."

Robin Levien,
Designer











“Striking design and smart hygiene make Sphero ideal for modern high-traffic washrooms.”

Robin Levien,
Designer



Enhanced water coverage

Hygienic flush

Spreader delivers enhanced hygiene with flush covering majority of bowl.



Anti-splash geometry

Concave bowl

Concave bowl and low outlet position inside the urinal prevents splashback onto the floor and clothing.

SCULPTED FOR SUPERIOR HYGIENE

Hygienic by design

Sphero's anti-splash geometry prevents splashback onto the floor and clothing. The rimless design makes it easier to clean, as does the nozzle spreader which delivers a more hygienic flush that covers most of the urinal.

The ceramic edges have been designed to reduce surface cleaning and stop water retention, preventing the spread of bacteria.

Fresher spaces

The waterless options contain an odour block cartridge which eliminates internal pipe odour, keeping the air around the urinal fresh and free from smells.

The cartridge needs changing on average every 3 months. It lasts for a maximum of 10,000 uses. For our Smart Hybrid models the sensor will indicate that a replacement is needed after 7,500 uses (default setting) via the spreader's integrated warning light.

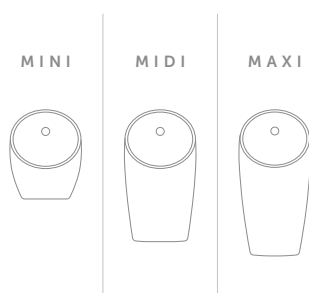

DESIGNED TO THINK AHEAD

Sensor technology

Predicting issues, preventing problems

The intelligent sensor inside the Sphero Hybrid models detects issues and provides feedback to aid maintenance and minimise water consumption.

If the sensor detects a blockage, or a cartridge or battery end of life, the spreader light will provide a distinctive warning alert for corrective maintenance. When a blockage is detected no more flushes will be triggered.

LED warning light

Issue	Blockage*	Cartridge replacement**	Battery replacement
LED flashing pattern	8 times	3 times	5 times

*In the event of a complete blockage flushing will be suspended.

**The LED warning light switches off only when the "Reset Cartridge" is initiated either through the application or the sensor button.

Blockage / slow flow

Sphero's smart sensor will detect and notify maintenance of any blockages.

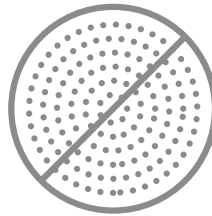

Low battery

A warning light will signal the battery needs to be replaced when 80% of the power has been used.

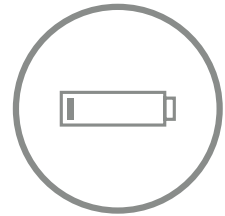

Flush failure

The smart sensors can also detect flush failure.

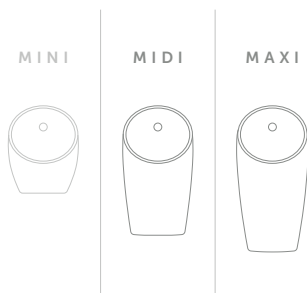

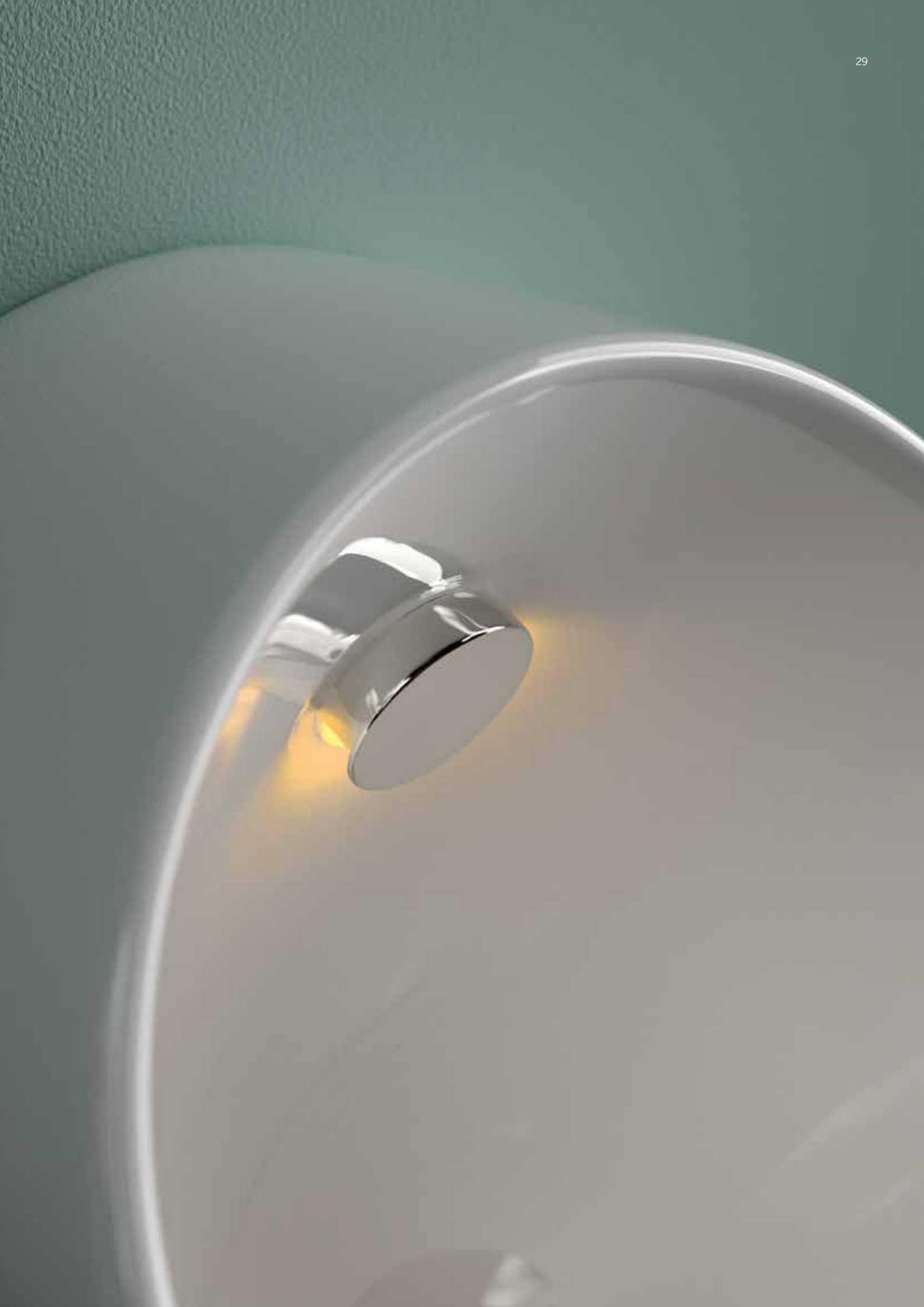

BUILT WITH THE FUTURE IN MIND

Flush modes

Crafted for economy

Sphero's Smart E-Hybrid feature lets you switch between three flush modes – Hybrid, Standard, and Waterless.*

On the default Hybrid mode, the smart sensor technology detects salinity and urinal use. When usage is detected a single flush is activated every 30 mins (frequency can be changed to 1, 3 or 6 hours), using just 0.85L water per flush (adjustable to 1.5, 2 or 3L). A hygiene flush will activate on an unused unit every 24 hours (optional 12 hours).

When switched to Standard mode, a flush is triggered 8 seconds after each detected use (optional settings of 6 or 10 seconds are available). Like in Hybrid mode, if no use is detected a hygiene flush is activated every 24 hours.

When the sensor detects 3 uses at intervals of less than 1 minute the urinal automatically switches to a Stadium mode, activating a rinse (at a much reduced quantity of water) on every use and a full flush on exit.

In Waterless mode the urinal will not flush – offering maximum water savings. There is a cartridge included for this mode in all Smart Hybrid Sphero models.



Hybrid mode



Standard mode



Waterless mode

Detection

Sphero detects the urine concentration, not human presence – reducing the frequency of flush.

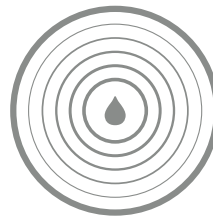

Rinsing

Sphero only rinses the bowl once the level of urine is high enough, saving water and ensuring cleanliness.

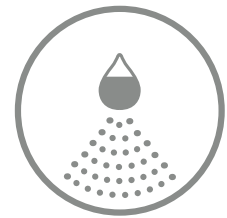

Stadium mode

In Standard mode when urinal usage is high, Sphero switches automatically to a Stadium mode, increasing flush frequency but using just 0.1L water per flush.

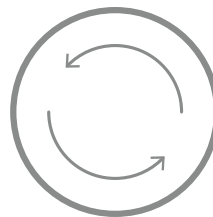

Hygiene flush

When in Hybrid mode, if the urinal is unused for 24 hours, a flush will be triggered automatically, helping to avoid odours and piping issues.

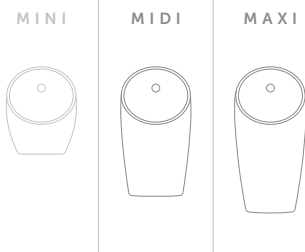

*For battery operated Smart Hybrid models an additional purchase of the Bluetooth module is required to switch between the three flush modes. The default setting is Hybrid mode.



Environmentally aware Economically friendly

As worldwide population figures continue to grow, so does our understanding of just how valuable a resource water is. With 40% of people unable to access clean water and 4.5 billion lacking safely managed sanitation, it's clear that saving water wherever possible should be a high priority.

That's where Sphero's Smart Hybrid models come in, offering the perfect balance between water-saving technology and greater hygiene levels. In high-traffic environments, Sphero's default Hybrid mode uses 10 times less water than Standard mode or other urinal actuators that flush after every use.

The sensor in hybrid models will detect the necessity to flush and will only do so after a fixed delay of half an hour. All uses happening within these 30 minutes will not trigger additional flushes. The flush volume is pre-set to deliver 0.85L per flush and a hygiene flush is programmed every 24 hours (factory setting).

The tables on the right show a comparison of usage impact on water consumption for Sphero's different flush modes: Standard, Waterless and Hybrid at factory settings. Modifying the Hybrid settings can reduce water consumption even further.

Low traffic

	Standard	Waterless	Hybrid
Usages per hour	2	2	2
Water consumption/flush	0.85L	0L	0.85L
Water consumption/hour	1.7L	0L	Max 1.74L

Medium traffic

	Standard	Waterless	Hybrid
Usages per hour	5	5	5
Water consumption/flush	0.85L	0L	0.85L
Water consumption/hour	4.25L	0L	Max 1.74L

High traffic

	Standard	Waterless	Hybrid
Usages per hour	20	20	20
Water consumption/flush	0.85L	0L	0.85L
Water consumption/hour	17L	0L	Max 1.74L

BREEAM and LEED

BREEAM and LEED are widely recognised Ecolabels that help businesses and new-build developments to make environmentally responsible choices.

Their aim is to reduce the consumption of drinkable water for sanitary use in new buildings from all sources through the use of water efficient components and water recycling systems.

BREEAM is an international scheme that assesses the environmental performance of a building. Developed by the Building Research Establishment (BRE), it acts as a third-party body, providing trained experts to measure sustainability levels. It is now the world's most highly recognised method of environmental grading and a high BREEAM rating is an assurance of quality, value and environmental responsibility.

Leadership in Energy and Environmental Design (LEED) is a North American rating system for high-quality environmental buildings. Since 1998, it has evolved to become a leading certification scheme for American buildings, as well as a reference point for the rest of the world. A high LEED rating offers huge advantages, such as instant environmental recognition, the guarantee of a healthier indoor space and a higher resale value.

Sphero's innovative water-saving features can help in boosting environmental ratings while delivering superior hygiene, making the range the perfect choice for any project.



BREEAM performance levels for water consumption of collective buildings

Use	Urinal	Urinals (2 or more)
Baseline	10 litres/bowl/hour	7.5 litres/bowl/hour
1 Credit	8 litres/bowl/hour	6 litres/bowl/hour
2 Credits	4 litres/bowl/hour	3 litres/bowl/hour
3 Credits	2 litres/bowl/hour	1.5 litres/bowl/hour
4 Credits	1 litres/bowl/hour	0.75 litres/bowl/hour
5 Credits	0 litres/bowl/hour	0 litres/bowl/hour

LEED performance levels for water consumption of new buildings

Use	Urinal
LEED 20% requirement	3.79 litres/bowl/hour
LEED 30% (2 points)	3.31 litres/bowl/hour
LEED 35% (3 points)	3.07 litres/bowl/hour
LEED 40% (4 points)	2.84 litres/bowl/hour

Easier maintenance
Hinge bracket

Using the Maxi's hinge bracket, you can pull the urinal away from the wall without detaching it, allowing you to perform maintenance tasks with ease.

Faster fitting
Installation template

Sphero Maxi has an easy-to-follow template to make installation simple and drilling precise. Its rubber seal protects the ceramic and walls, provides a neater aesthetic, and removes the need for a silicone sealant.

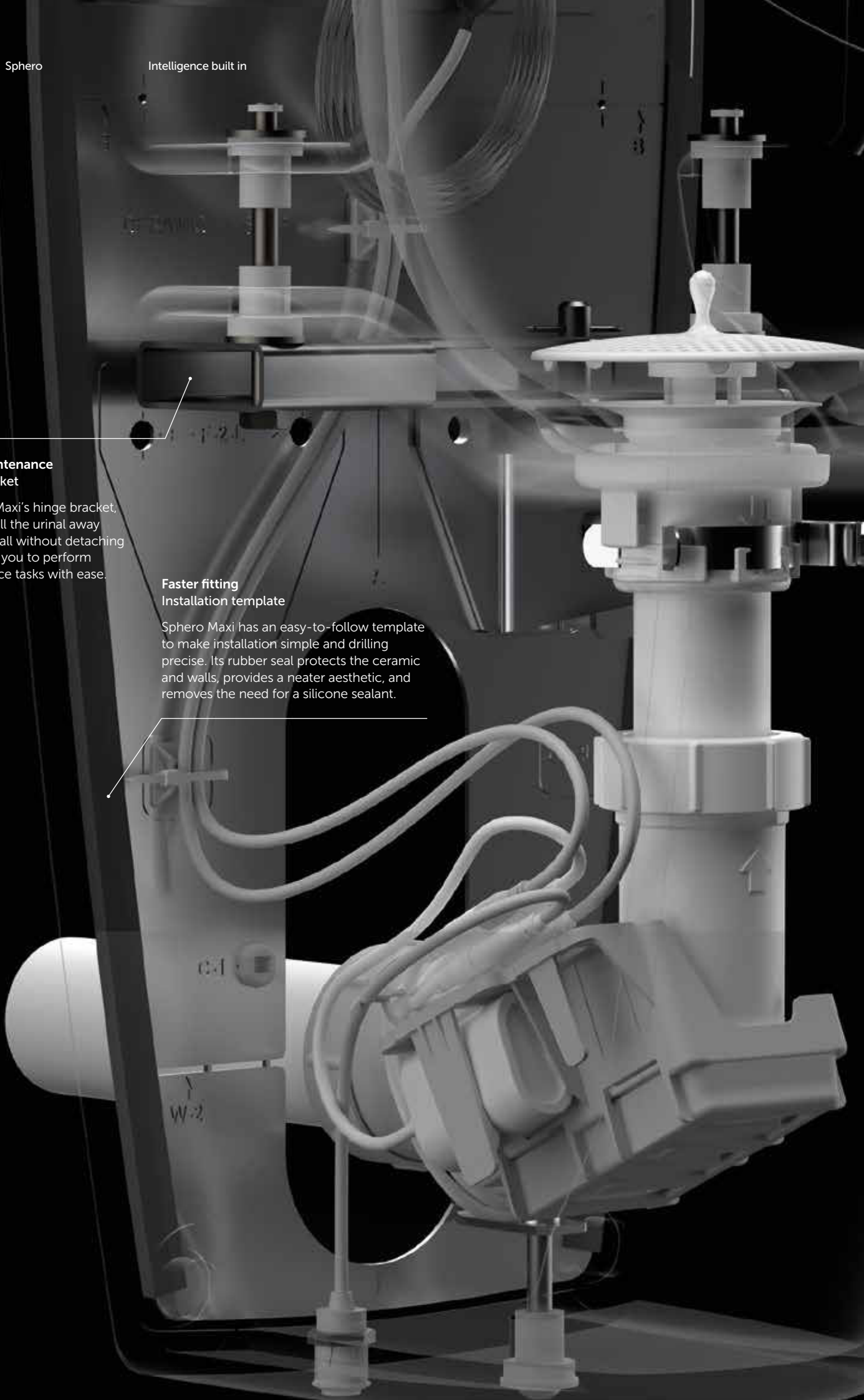

ENGINEERED FOR EASIER MAINTENANCE

Mobile app

Created for total control

The Bluetooth module in Sphero Maxi's E-Hybrid model sends information on each urinal directly to our easy-to-use app.

Check sensor status, power, flow issues, cartridge life and usage statistics from your phone or tablet.

The app can also apply a profile template to a number of urinals. This allows building owners and facilities managers to apply changes to urinals simultaneously – saving time and resources.

You can also connect to our Gateway for Cloud/WMS – allowing urinals to be monitored continuously and controlled remotely.



MINI

MIDI

MAXI



PRODUCT
PORTFOLIO



TRADITIONAL FLUSH



Sphero Mini Back Inlet
Urinal Exposed Trap BI
E182801

Sphero Mini Top Inlet
Urinal Exposed Trap TI
E189301



Sphero Midi Back Inlet
Urinal Open Shroud BI
E183101

Sphero Midi Top Inlet
Urinal Open Shroud TI
E189501



Sphero Maxi
Urinal Closed Shroud
E183201

DESIGN & SPECIFICATION

Modern spherical design
Enhancement of aesthetic design for the washroom with a contemporary look and excellent space efficiency.

Urinal & key components under one SKU
Easy to specify and cost effective with additional components designed specifically for different installation types.

Tamper-proof
Fully closed/shrouded design on the Maxi for added security in public washrooms and high-traffic environments.

WATER EFFICIENCY & HYGIENE

Anti-splash geometry
Concave bowl and low outlet position inside the urinal prevents splashback onto the floor and clothing.

Enhanced water coverage
Spreader delivers enhanced hygiene with flush covering majority of bowl.

Rimless bowls
Eliminates hidden surfaces and build-up of stagnant water.

INSTALLATION

Back and top inlet options
Easy to specify for concealed or exposed installation.

Easy fix hanger
Consistent across range and easy, quick install.

Rubber seal and installation template¹
Easy installation and precise drilling. Protection of walls and ceramic. Improved aesthetics, no need for silicone sealant.

MAINTENANCE

Top fixed waste
Easy and quick access with supplied service key allowing for on-wall maintenance.

Service and spares
Replacement parts available to order.

1. Available as an option/accessory to be purchased in addition to the SKU for Midi and Maxi.

WATERLESS



Sphero Mini Waterless
Urinal Exposed Trap Waterless
E189401

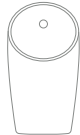

Sphero Midi Waterless
Urinal Open Shroud Waterless
E189601



DESIGN & SPECIFICATION

Modern spherical design
Enhancement of aesthetic design for the washroom with a contemporary look and excellent space efficiency.

Urinal & key components under one SKU

Easy to specify and cost effective with additional components designed specifically for different installation types.

WATER EFFICIENCY & HYGIENE

Water saving, reduces odours
Waterless option with odour block cartridge. Cartridges only need to be changed every two months (on average).

Anti-splash geometry
Concave bowl and low outlet position inside the urinal prevents splashback onto the floor and clothing.

Rimless bowls
Eliminates hidden surfaces and further simplifies cleaning.

INSTALLATION

Easy fix hanger
Consistent across range and easy, quick install.

MAINTENANCE

Top fixed waste
Easy and quick access with supplied service key allowing for on-wall maintenance.

Service and spares
Replacement parts available to order.

SMART HYBRID FLUSH

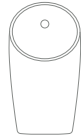

Sphero Midi Smart Hybrid
Urinal Open Shroud –
Sensor & Battery Pack
E208401



Sphero Maxi Smart E-Hybrid
Urinal Closed Shroud –
Sensor & Mains Connection
E189701

Sphero Maxi Smart Hybrid
Urinal Closed Shroud –
Sensor & Battery Pack
E208501

DESIGN & SPECIFICATION

Modern spherical design
Enhancement of aesthetic design for the washroom with a contemporary look and excellent space efficiency.

Options to suit the installation type
The Maxi urinal has electronic options for mains or battery type installation.

Tamper-proof
Fully closed/shrouded design on the Maxi for added security in public washrooms and high-traffic environments. An anti-vandal bracket (E202767) is available in combination with the easy maintenance bracket.

WATER EFFICIENCY & HYGIENE

Anti-splash geometry
Concave bowl and low outlet position inside the urinal prevents splashback onto the floor and clothing.

Smart sensor technology¹
Smart Hybrid sensor technology detects salinity and urinal use. Single flush activated at default set every 30 mins (at 0.85L per flush). 24 hour hygiene flush if no usage. Maxi model recommended for full control.

Smart E-Hybrid sensor technology
Building on Hybrid sensor technology, all settings can be changed. Operated via app. Settings can be applied to all urinals connected to app. Default is Hybrid mode. Can be changed to Standard flush or Waterless.

Rimless bowls
Eliminates hidden surfaces and build-up of stagnant water.

INSTALLATION

Integrated components
All technical components linked to the ceramic are preinstalled.

Rubber seal and installation template²
Easy installation and precise drilling. Protection of walls and ceramic. Improved aesthetics, no need for silicone sealant.

Mobile app³
Easy use app for mobile or tablet allowing facilities managers and building owners to access information about the urinal remotely. Provides diagnostic status and option to change settings if necessary. Preset for easy installation.













MAINTENANCE

Intelligent sensor
Detects flow and waste blockage issues and warning light activated. Diagnostic data available for corrective action.

Easy maintenance hinged bracket (Maxi only)
Urinal swings easily off the wall without any need for disconnection for ease of access to traps etc. for improved maintenance regimes.

LED warning light
Flashes 8 times when there is a blockage, 5 times when the battery needs to be replaced or 3 times when the cartridge needs replacing.

Key

-  Easy installation
-  Rimless bowl
-  Battery operated
-  Mains operated
-  Smart sensor
-  Warning light
-  App compatibility
-  Easy maintenance bracket
-  Hybrid mode
-  Standard mode
-  24 hour hygiene flush
-  Waterless/waterless mode

Sphero Mini Back Inlet
 Urinal Exposed Trap BI
 E182801



Sphero Mini Top Inlet
 Urinal Exposed Trap TI
 E189301



- Rimless urinal bowl
- Anti-splash geometry of the inner bowl
- Back inlet connection pack included with flexible hose and isolating valve
- Branded spreader with check valve and flow regulator
- Easy maintenance top fixed waste
- Easy fixation hanger



- Rimless urinal bowl
- Anti-splash geometry of the inner bowl
- Top inlet connection pack included with flexible hose and white cap
- Branded spreader with check valve and flow regulator
- Easy maintenance top fixed waste
- Easy fixation hanger

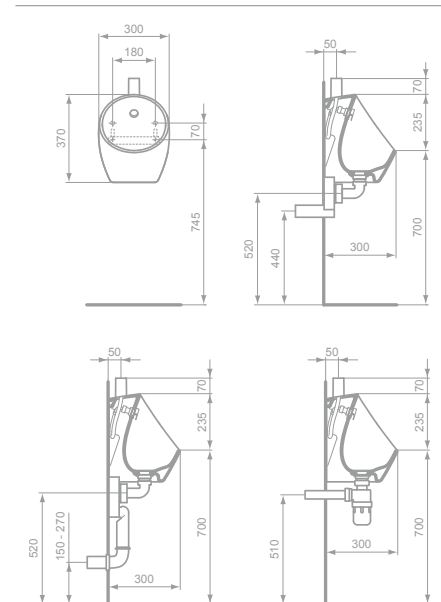
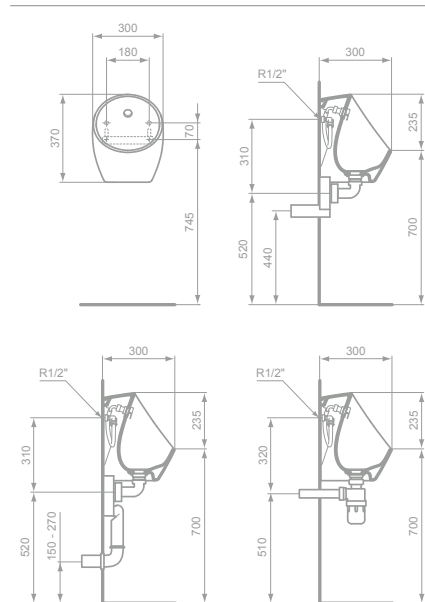

Sphero Mini Waterless
Urinal Exposed Trap Waterless
E189401



- Rimless urinal bowl for Waterless system
- Anti-splash geometry of the inner bowl
- Branded spreader cap
- Easy maintenance top fixed waste
- Waterless grate and odour block cartridge with service key included*
- Easy fixation hanger

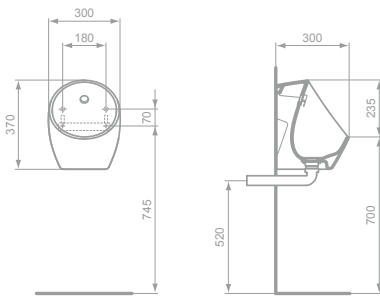

Sphero Midi Back Inlet
Urinal Open Shroud BI
E183101



- Rimless urinal bowl
- Anti-splash geometry of the inner bowl
- Back inlet connection pack included with flexible hose and isolating valve
- Branded spreader with check valve and flow regulator
- Easy maintenance top fixed waste
- Easy fixation hanger

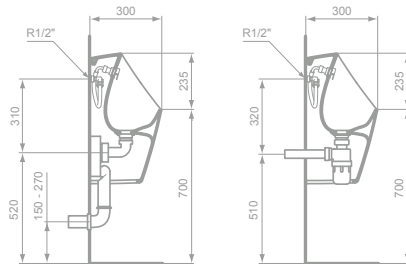
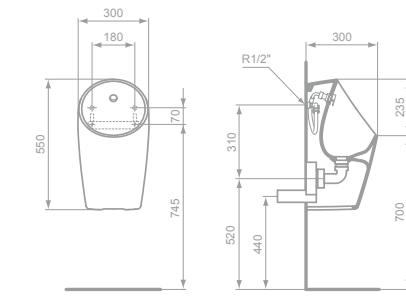

Sphero Midi Top Inlet
Urinal Open Shroud TI
E189501



- Rimless urinal bowl
- Anti-splash geometry of the inner bowl
- Top inlet connection pack included with flexible hose and white cap
- Branded spreader with check valve and flow regulator
- Easy maintenance top fixed waste
- Easy fixation hanger

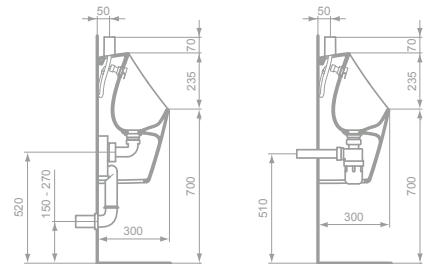
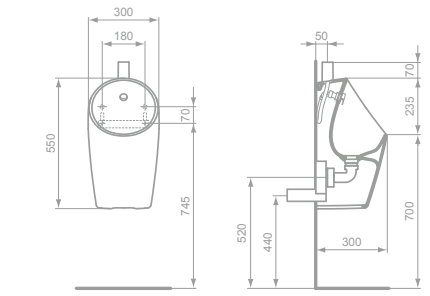

*As soon as the green key ring is empty, the key valve needs to be replaced. This occurs after approximately 7,500 usages. Depending on usage, it must be replaced 2 to 3 times per year. Therefore each valve can save 20,000-40,000 litres of water.

Sphero Midi Waterless
Urinal Open Shroud Waterless
E189601



- Rimless urinal bowl for Waterless system
- Anti-splash geometry of the inner bowl
- Branded spreader cap
- Easy maintenance top fixed waste
- Waterless grate and odour block cartridge with service key included*
- Easy fixation hanger

Sphero Midi Smart Hybrid
Urinal Open Shroud –
Sensor & Battery Pack
E208401



- Rimless urinal bowl
- Anti-splash geometry of the inner bowl
- Branded spreader with check valve and flow regulator
- Easy fixation hanger
- Easy maintenance top fixed waste and grate cap for reinforced anti-splash and blockage protection
- Predictive maintenance: Visual alert with LED in spreader upon detection of blockage and slow flow, low battery or Hybrid cartridge end of life

Smart Sensor

The sensor detects the urine concentration not human presence

Midi Hybrid (with battery pack)

Default setting: Hybrid mode at 30 min interval upon detection

A hygiene flush is activated every 24 hours

Sphero Maxi
Urinal Closed Shroud
E183201



- Rimless urinal bowl
- Anti-splash geometry of the inner bowl
- Back inlet connection pack included with flexible and isolating valve
- Branded spreader with check valve and flow regulator
- Easy fixation hanger
- Easy maintenance top fixed waste

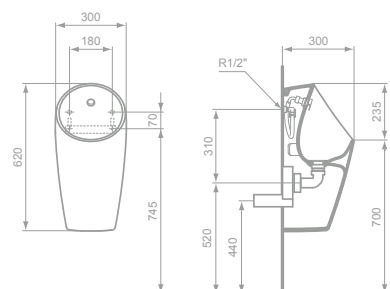
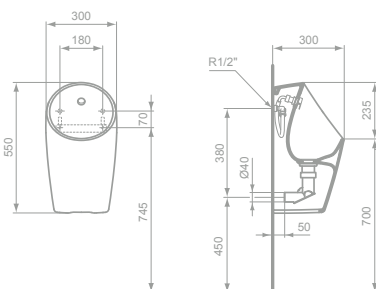
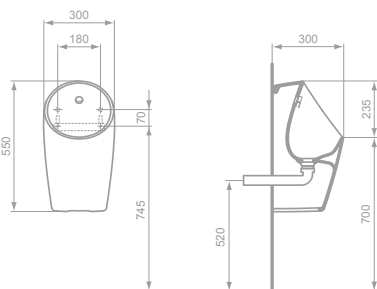

*As soon as the green key ring is empty, the key valve needs to be replaced. This occurs after approximately 7,500 usages. Depending on usage, it must be replaced 2 to 3 times per year. Therefore each valve can save 20,000-40,000 litres of water.

Sphero Maxi Smart Hybrid
Urinal Closed Shroud –
Sensor & Battery Pack
E208501



- Rimless urinal bowl
- Anti-splash geometry of the inner bowl
- Branded spreader with check valve and flow regulator
- Easy fixation hanger
- Urinal Installation Template for quick installation and with rubber seal to protect the ceramic against the wall as a water seal
- Easy maintenance bracket with hinged arm swings the ceramic off the wall for easy access to parts and waste (the ceramic is retained to the wall/kept off the floor)
- Easy maintenance top fixed waste and grate cap for reinforced anti-splash and blockage protection
- Predictive maintenance: Visual alert with LED in spreader upon detection of blockage and slow flow, low battery or Hybrid cartridge end of life

Smart Sensor

The sensor detects the urine concentration not human presence

Maxi Hybrid (with battery pack)

Default setting: Hybrid mode at 30 min interval upon detection

A hygiene flush is activated every 24 hours

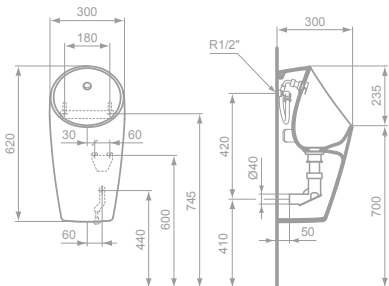

Sphero Maxi Smart E-Hybrid
Urinal Closed Shroud –
Sensor & Mains Connection
E189701



- Rimless urinal bowl
- Anti-splash geometry of the inner bowl
- Branded spreader with check valve and flow regulator
- Easy fixation hanger
- Urinal Installation Template for quick installation and with rubber seal to protect the ceramic against the wall as a water seal
- Easy maintenance bracket with hinged arm to swing out the ceramic for easy access to parts and waste (the ceramic is retained to the wall/kept off the floor)
- Easy maintenance top fixed waste and grate cap for reinforced anti-splash and blockage protection
- Predictive maintenance: Visual alert with LED in spreader upon detection of blockage and slow flow, low battery or Hybrid cartridge end of life

Smart Sensor

The sensor detects the urine concentration not human presence

Building Management System (BMS) mobile app & smart systems

Usage data reporting, error/failure reporting, power status and multi-connectivity

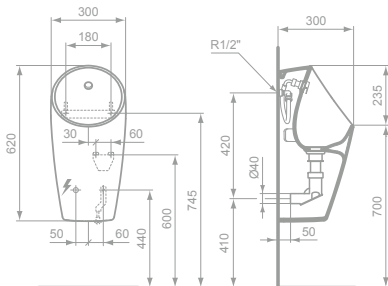

Maxi E-Hybrid (on mains)

Profile settings can be defined and applied to a set of urinals
3 flush modes can be selected via the app:

Hybrid mode

Upon detecting usage, a single flush is activated every 30 mins, using just 0.85L water per flush

The frequency between flushes can be set to 1, 3, and 6 hour intervals

A hygiene flush is actuated every 24 hours

Standard mode

When switched to Standard mode, a flush is triggered 8 seconds after each detected use (optional settings of 6 or 10 seconds are available)

When 3 usages are detected with less than 1 minute intervals between each use the urinal automatically switches to a Stadium mode, activating a rinse on every use

A hygiene flush is activated every 24 hours

Waterless mode

The urinal will not flush, a Hybrid cartridge is included in the waste

ACCESSORIES

Accessory Matrix	Traditional	Waterless	Hybrid	E-Hybrid
Top Inlet Cap Chrome E2075AA	Top inlet only			
Urinal Toggle Bolts S927667	•	•	•	•
1M Solenoid Valve Extension Cable E206767				•
Anti-vandal Bracket E202767	Only for Maxi model		Only for Maxi model	•
Easy Maintenance Bracket E202267			Included in Maxi pack and available for Midi	Included in pack
Grate Cap E202567	•		•	•
Installation Template & Seal E202667	Available for Midi for improved maintenance access		Included in Maxi pack and available for Midi	Included in pack
Bottle Trap 1½" Plastic Bottle S891567	•			
FlexiWaste E202367	•	•	Included in pack	Included in pack
Waterless 1 1/2 Space Saver Pipe EEEV50167		•		
Urinal Hybrid Cartridge EW03367			•	•
Urinal Waterless Cartridge RV06167		•		
Battery for Sensor E206867			•	
Spreader LED E214367			•	•
IS Service Key E202867	•	•	•	•
ProSys Universal Urinal Frame with top recessed fixing panel for built in or infrared urinal flush control R016367	Back inlet installation			
ProSys Basic Urinal Frame for exposed manual urinal flush control R010367	•	•	•	•
Strut for Hinged Easy Maintenance Bracket R010467			•	•
Septa Pro U2 F/Plate Chrome P0115AA	•			
Septa Pro U3 F/Plate White R0139AC	•			
Septa Pro U3 F/Plate Chrome R0139AA	•			
Septa Pro U3 F/Plate Matt Chrome R0139JG	•			

Urinal Install Template & Seal
E202667



Easy Maintenance Bracket
E202267



Anti-vandal Bracket
E202767



FlexiWaste
E202367



Grate Cap
E202567



Septa Pro U2
P0115AA



Septa Pro U3
R0139AC/R0139AA/R0139JG



ProSys Universal Urinal Frame
R016367



ProSys Urinal Frame
R010367



Compatible with all wall-hung urinals
For built-in installation into masonry and plasterboard constructed walls
Height adjustable legs from 0 to 300mm
Easy and quick installation with EasyFix™ wall brackets
Adjustable depth 120 > 170
Adjustable height attachment bars
Top recessed fixing panel for built-in or infrared urinal flush control
Frame load tested to 100kg
Supplied with all frame fixings
Outlet bend 50/50mm
Outlet bend seal 50mm
1 angled wall connector ½ F x ½ M

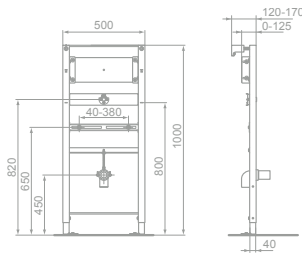

Compatible with all wall-hung urinals
For installation with the E-Hybrid/Hybrid models using the Easy Maintenance Bracket combine with strut R010467
For built-in installation into masonry and plasterboard constructed walls
Height adjustable legs from 0 to 300mm
Easy and quick installation with EasyFix™ wall brackets
Adjustable depth 120 > 170
Adjustable height attachment bars
For exposed manual urinal flush control
Frame load tested to 100kg
Supplied with all frame fixings
Outlet bend 50/50mm
Outlet bend seal 50mm
1 angled wall connector ½ F x ½ M

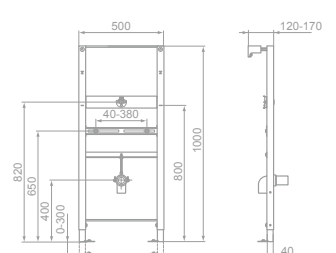

Together we positively impact the future of modern living. Together we think bigger. Together we establish the rules for considered design. Together we bring emotion to functional perfection. Together we form enduring partnerships. Together we meet the needs of all generations. Together we shape the future of the category we have defined.

Together for Better.



Ideal Standard

Ideal Standard-Vidima AD

53 Marin Popov Street
5400 Sevlievo, Bulgaria
Tel: +359 675 30362
office@idealstandard.com

Representative office, Riga

A. Briana str. 9a,
Riga, LV- 1001, Latvia
Tel: +371 67357 792
Fax: +371 67357 795
vdorogoi@idealstandard.com

Representative Office, Bucharest

Cotroceni Business Center
Bd. Iuliu Maniu, nr 7, corp T,
Floor 2, office A1, Sector 6
061072 Bucharest, Romania
Tel/Fax: +40 21 322 3201
officebucharest@idealstandard.com

Representative office, Belgrade

Drinčićeva no.19, apartment no.8
11000 Belgrade, Serbia
Tel/Fax: + 381 11 7138 058
+ 381 11 7138 059
obelgrade@idealstandard.com

Representative Office, Budapest

IS-Hun Kft
1221 Budapest, Hungary
Aranyfácán u 20
Tel: + 36 30 6991594
zgarai@idealstandard.com

Contact for Albania, Kosovo

and Bosnia & Herzegovina
Tel: +359 887709696
imichev@idealstandard.com

Contact for Croatia

Mobile: +38591 22 99 304
hpavicic@idealstandard.com

Contact for Slovenia

Tel: +39 040 2158058
info@liaison.it

Guarantee

**Lifetime on all ceramic products
(ceramic parts only)**

Electronics/components* – 2
years warranty

* warranty does not cover
replacement items - Hybrid
cartridge, Cartridge kit, Gate
cap, Service key, Spreader LED,
Battery

Products must be installed,
used and cared for in line with
our fixing instructions and local
water regulations, and room
must be adequately ventilated.

All measurements are in
millimetres and are approximate



Ideal Standard